

380



Kugelhähne innen/innen mit PTFE-Stopfbuchspackung Female/female ball valves with PTFE seal

TRINKWASSER
DRINKING WATER

VOLLER DURCHGANG
FULL BORE

Für Sanitär- und Heizungsinstallationen, auch für den Trinkwasserverbrauch geeignet. Für den Einbau in Mittel- und Hochdruckanlagen zur Wasserverteilung, industriellen und zivilen Heizsystemen sowie pneumatischen Anlagen mit nicht aggressiven Medien.

For plumbing and heating systems, drinking water consumption. Installation in medium and high pressure industrial and civil heating systems, pneumatic systems and for non-aggressive fluids.

PN40

MADE IN ITALY



**AUSSEN
VERNICKELT**
EXTERNALLY
NICKEL-PLATED



VERNICKELT
NICKEL-PLATED

Betriebsdruck: siehe Tabellen

Betriebstemperatur: -30°C +150°C (kein Frost)

Zylindrische Gewinde nach ISO 228-1

Spindeldichtung:

- 1/2" bis 3"- Spindel von innen mit 1 EPDM-PEROX-O-Ring und PTFE-Stopfbuchspackung montiert und mit Stellmutter verstellbar;

- 1/8", 1/4", 3/8" und 4" - Spindel von außen mit PTFE-Stopfbuchspackung montiert und mit Stellmutter verstellbar;

Kugeldichtung mit 2 PTFE-Kugeldichtungen

Voller Durchgang

Working pressure: see tables

Working temperature: -30°C +150°C (no frost)

Cylindrical threads according to ISO 228-1

Seal on the stem:

- from 1/2" to 3" stem assembled from inside with 1 EPDM PEROX OR, PTFE seal and adjustable packing gland;

- 1/8" 1/4", 3/8" and 4" stem assembled from outside with PTFE seal and adjustable packing gland;

Seal on the ball with 2 PTFE gaskets

Full bore

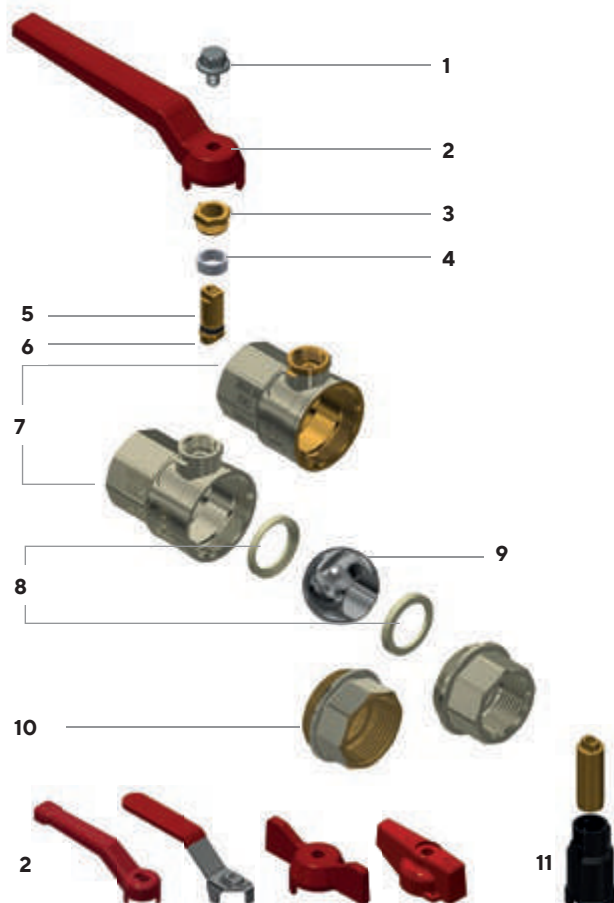

- 1 Schraube aus Edelstahl AISI 430
- 2 Verfügbare Hebel: siehe Tabellen unten
- 3 Einstellring aus CW614N UNI EN 12164
- 4 PTFE-Stopfbuchring
- 5 Spindel aus CW614N UNI EN 12164
- 6 O-Ring aus EPDM PEROX
- 7 Ventilkörper aus CW617N UNI EN 12165 vernickelt oder nur außen vernickelt - je nach Modell (siehe Tabelle)
- 8 PTFE-Kugeldichtung
- 9 Kugel aus CW617N UNI EN 12165 verchromt
- 10 Muffe aus CW617N UNI EN 12165 vernickelt oder nur außen vernickelt - je nach Modell (siehe Tabelle)
- 11 Für Versionen 1/2" und 3/4", Verlängerungshülse aus Kunststoff PA6, 50% glasfaserverstärkt, andere Ausführungen aus vernickeltem CW617N UNI EN 12165.

- 1 AISI 430 steel screw
- 2 Available levers: see following tables
- 3 CW614N UNI EN 12164 packing gland
- 4 PTFE ring seal
- 5 CW614N UNI EN 12164 stem
- 6 O-Ring aus EPDM PEROX
- 7 CW617N UNI EN 12165 body valve, nickel-plated or nickel-plated on the external surface
- 8 PTFE gasket
- 9 CW617N UNI EN 12165 chrome-plated ball
- 10 CW617N UNI EN 12165 end adaptor, nickel-plated or nickel-plated on the external surface
- 11 For 1/2" and 3/4" versions extension made of plastic sleeve PA6 loaded 50% glass fibre, other versions of nickel-plated CW617N UNI EN 12165



Mit Aluminium-Hebel
With aluminium lever

AUSSEN VERNICKELT
EXTERNALLY NICKEL-PLATED

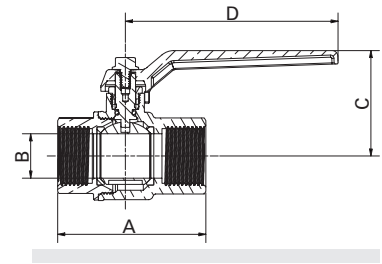

Anschlüsse Connections	Produktcode Product code	PN	A ±1mm	B mm	C mm	D mm	VE klein/groß* Pack. num. pieces*	
1/8"	380A1/8G5R	380A1/8G5B	40	48	11	41	95	-
1/4"	380B1/4G5R	380B1/4G5B	40	48	11	41	95	-
3/8"	380C3/8G5R	380C3/8G5B	40	48	11	41	95	-
1/2"	380D1/2G5R	380D1/2G5B	60	58	15	43,5	95	-
3/4"	380E3/4G5R	380E3/4G5B	60	66	20	47	95	-
1"	380F001G5R	380F001G5B	40	80	25	62,5	115	-
1" 1/4	380G11/4G5R	380G11/4G5B	40	97	32	67,5	115	-
1" 1/2	380H11/2G5R	380H11/2G5B	40	107	40	80	165	-
2"	380I002G5R	380I002G5B	40	131	50	88	165	-

* Bitte kontaktieren Sie das Unternehmen für Informationen über Verpackung und Mengen.
* For details on packaging and quantities, please contact the company.



VERNICKELT
NICKEL-PLATED

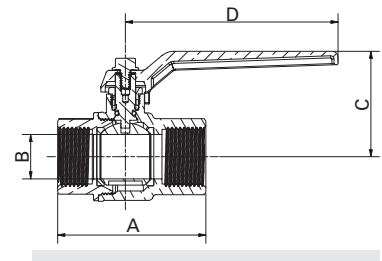

Anschlüsse Connections	Produktcode Product code	PN	A ±1mm	B mm	C mm	D mm	VE klein/groß* Pack. num. pieces*	
1/8"	380A1/8C5R	380A1/8C5B	40	48	11	41	95	-
1/4"	380B1/4C5R	380B1/4C5B	40	48	11	41	95	-
3/8"	380C3/8C5R	380C3/8C5B	40	48	11	41	95	-
1/2"	380D1/2C5R	380D1/2C5B	60	58	15	43,5	95	-
3/4"	380E3/4C5R	380E3/4C5B	60	66	20	47	95	-
1"	380F001C5R	380F001C5B	40	80	25	62,5	115	-
1" 1/4	380G11/4C5R	380G11/4C5B	40	97	32	67,5	115	-
1" 1/2	380H11/2C5R	380H11/2C5B	40	107	40	80	165	-
2"	380I002C5R	380I002C5B	40	131	50	88	165	-

* Bitte kontaktieren Sie das Unternehmen für Informationen über Verpackung und Mengen.
* For details on packaging and quantities, please contact the company.



Hebel aus tiefgezogenem Stahl With drawn steel lever

AUSSEN VERNICKELT
EXTERNALLY NICKEL-PLATED

TRINKWASSER
DRINKING WATER

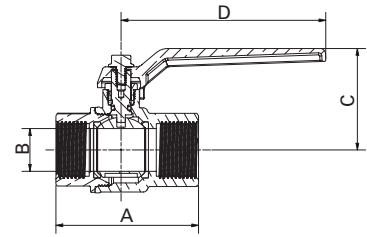

Anschlüsse
Connections

Produktcode
Product code

PN

A
±1mm

B
mm

C
mm

D
mm

VE klein/groß
Pack. num. pieces



1/8"	380A1/8G1R	380A1/8G1B	40	48	11	44	83	12/144
1/4"	380B1/4G1R	380B1/4G1B	40	48	11	44	83	12/144
3/8"	380C3/8G1R	380C3/8G1B	40	48	11	44	83	12/144
1/2"	380D1/2G1R	380D1/2G1B	60	58	15	46	83	10/120
3/4"	380E3/4G1R	380E3/4G1B	60	66	20	49,5	83	6/72
1"	380F001G1R	380F001G1B	40	80	25	68	90	4/48
1" 1/4	380G11/4G1R	380G11/4G1B	40	97	32	73	90	10
1" 1/2	380H11/2G1R	380H11/2G1B	40	107	40	82	160	10
2"	380I002G1R	380I002G1B	40	131	50	90	160	10
2" 1/2	380L21/2G1R	-	40	155	62	140	240	2
3"	380M003G1R	-	40	176	74	145	240	2
4" *	380N004G1N	-	10	178	94	142	229	1

* Nur mit schwarzem Hebel erhältlich. Available only with black lever.



VERNICKELT
NICKEL-PLATED

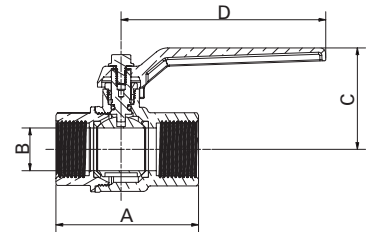

Anschlüsse
Connections

Produktcode
Product code

PN

A
±1mm

B
mm

C
mm

D
mm

VE klein/groß
Pack. num. pieces





1/8"	380A1/8C1R	380A1/8C1B	40	48	11	44	83	12/144
1/4"	380B1/4C1R	380B1/4C1B	40	48	11	44	83	12/144
3/8"	380C3/8C1R	380C3/8C1B	40	48	11	44	83	12/144
1/2"	380D1/2C1R	380D1/2C1B	60	58	15	46	83	10/120
3/4"	380E3/4C1R	380E3/4C1B	60	66	20	49,5	83	6/72
1"	380F001C1R	380F001C1B	40	80	25	68	90	4/48
1" 1/4	380G11/4C1R	380G11/4C1B	40	97	32	73	90	10
1" 1/2	380H11/2C1R	380H11/2C1B	40	107	40	82	160	10
2"	380I002C1R	380I002C1B	40	131	50	90	160	10
2" 1/2	380L21/2C1R	-	40	155	62	140	240	2
3"	380M003C1R	-	40	176	74	145	240	2

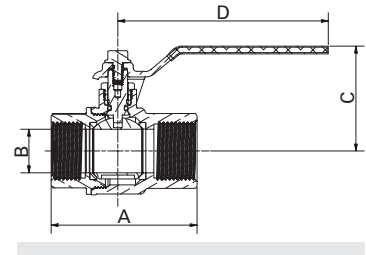

Mit Flachhebel aus Edelstahl AISI 304
With AISI 304 stainless steel flat lever

AUSSEN VERNICKELT
EXTERNALLY NICKEL-PLATED





Anschlüsse Connections	Produktcode Product code	PN	A ±1mm	B mm	C mm	D mm	VE klein/groß Pack. num. pieces	
								
1/8"	380A1/8G4R	380A1/8G4B	40	48	11	41	95	12/144
1/4"	380B1/4G4R	380B1/4G4B	40	48	11	41	95	12/144
3/8"	380C3/8G4R	380C3/8G4B	40	48	11	41	95	12/144
1/2"	380D1/2G4R	380D1/2G4B	60	58	15	43,5	95	10/120
3/4"	380E3/4G4R	380E3/4G4B	60	66	20	47	95	6/72
1"	380F001G4R	380F001G4B	40	80	25	60,5	115	3/36
1" 1/4	380G11/4G4R	380G11/4G4B	40	97	32	65,5	115	10
1" 1/2	380H11/2G4R	380H11/2G4B	40	107	40	77,5	165	10
2"	380I002G4R	380I002G4B	40	131	50	85,5	165	10

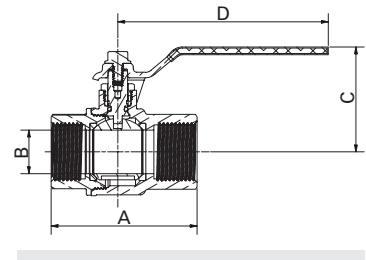

VERNICKELT
NICKEL-PLATED



Anschlüsse Connections	Produktcode Product code	PN	A ±1mm	B mm	C mm	D mm	VE klein/groß Pack. num. pieces	
								
1/8"	380A1/8C4R	380A1/8C4B	40	48	11	41	95	12/144
1/4"	380B1/4C4R	380B1/4C4B	40	48	11	41	95	12/144
3/8"	380C3/8C4R	380C3/8C4B	40	48	11	41	95	12/144
1/2"	380D1/2C4R	380D1/2C4B	60	58	15	43,5	95	10/120
3/4"	380E3/4C4R	380E3/4C4B	60	66	20	47	95	6/72
1"	380F001C4R	380F001C4B	40	80	25	60,5	115	3/36
1" 1/4	380G11/4C4R	380G11/4C4B	40	97	32	65,5	115	10
1" 1/2	380H11/2C4R	380H11/2C4B	40	107	40	77,5	165	10
2"	380I002C4R	380I002C4B	40	131	50	85,5	165	10





Mit Aluminium-T-Griff With aluminium "T" handle

AUSSEN VERNICKELT
EXTERNALLY NICKEL-PLATED

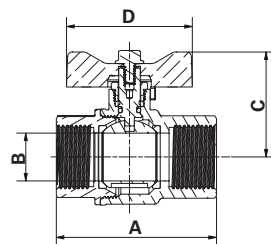
 **TRINKWASSER**
DRINKING WATER





Anschlüsse Connections	Produktcode Product code	PN	A ±1mm	B mm	C mm	D mm	VE klein/groß Pack. num. pieces	
 								
1/8"	380A1/8G6R	380A1/8G6B	40	48	11	37,5	52	12/144
1/4"	380B1/4G6R	380B1/4G6B	40	48	11	37,5	52	12/144
3/8"	380C3/8G6R	380C3/8G6B	40	48	11	37,5	52	12/144
1/2"	380D1/2G6R	380D1/2G6B	60	58	15	39,6	52	10/120
3/4"	380E3/4G6R	380E3/4G6B	60	66	20	43,4	52	6/72
1"	380F001G6R	380F001G6B	40	80	25	51,6	65	4/48

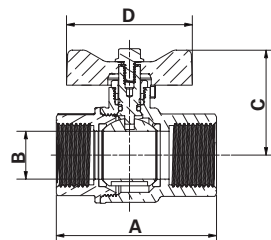

VERNICKELT
NICKEL-PLATED





Anschlüsse Connections	Produktcode Product code	PN	A ±1mm	B mm	C mm	D mm	VE klein/groß Pack. num. pieces	
 								
1/8"	380A1/8C6R	380A1/8C6B	40	48	11	37,5	52	12/144
1/4"	380B1/4C6R	380B1/4C6B	40	48	11	37,5	52	12/144
3/8"	380C3/8C6R	380C3/8C6B	40	48	11	37,5	52	12/144
1/2"	380D1/2C6R	380D1/2C6B	60	58	15	39,6	52	10/120
3/4"	380E3/4C6R	380E3/4C6B	60	66	20	43,4	52	6/72
1"	380F001C6R	380F001C6B	40	80	25	51,6	65	4/48

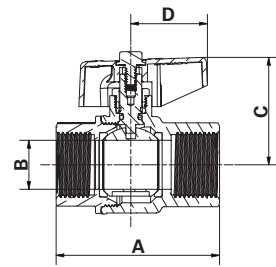

Mit Drehknopf aus Aluminium
With aluminium knob

AUSSEN VERNICKELT
EXTERNALLY NICKEL-PLATED





Anschlüsse Connections	Produktcode Product code	PN	A ±1mm	B mm	C mm	D mm	VE klein/groß Pack. num. pieces
 							
1/8"	380A1/8G2R 380A1/8G2B	40	48	11	34	31,5	12/144
1/4"	380B1/4G2R 380B1/4G2B	40	48	11	34	31,5	12/144
3/8"	380C3/8G2R 380C3/8G2B	40	48	11	34	31,5	12/144
1/2"	380D1/2G2R 380D1/2G2B	60	58	15	40	31,5	10/120
3/4"	380E3/4G2R 380E3/4G2B	60	66	20	43,5	31,5	6/72
1"	380F001G2R 380F001G2B	40	80	25	54	42,5	4/48
1" 1/4	380G11/4G2R 380G11/4G2B	40	97	32	68	50	10

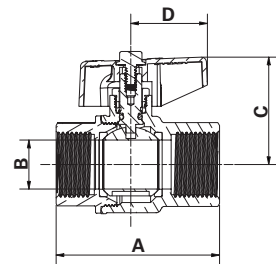

VERNICKELT
NICKEL-PLATED



Anschlüsse Connections	Produktcode Product code	PN	A ±1mm	B mm	C mm	D mm	VE klein/groß Pack. num. pieces
 							
1/8"	380A1/8C2R 380A1/8C2B	40	48	11	34	31,5	12/144
1/4"	380B1/4C2R 380B1/4C2B	40	48	9	34	31,5	12/144
3/8"	380C3/8C2R 380C3/8C2B	40	48	11	34	31,5	12/144
1/2"	380D1/2C2R 380D1/2C2B	60	58	15	40	31,5	10/120
3/4"	380E3/4C2R 380E3/4C2B	60	66	20	43,5	31,5	6/72
1"	380F001C2R 380F001C2B	40	80	25	54	42,5	4/48
1" 1/4	380G11/4C2R 380G11/4C2B	40	97	32	68	50	10



Mit Verlängerung und Aluminium-Hebel With extension stem and aluminium lever



AUSSEN VERNICKELT EXTERNALLY NICKEL-PLATED

Für Versionen 1/2" und 3/4", Verlängerungshülse aus Kunststoff PA6, 50% glasfaserverstärkt, für die Ausführungen von 1" bis 2" aus vernickeltem CW617N UNI EN 12165.

For 1/2" and 3/4" versions extension made of plastic sleeve PA6 loaded 50% glass fibre, for 1" to 2" versions of nickel-plated CW617N UNI EN 12165

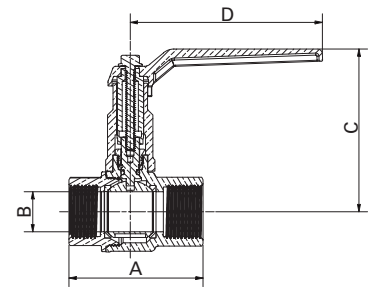
 **TRINKWASSER**
DRINKING WATER



Anschlüsse Connections	Produktcode Product code		PN	A ±1mm	B mm	C mm	D mm	VE klein/groß* Pack. num. pieces*
 								
1/2"	380D1/2G5RFM	380D1/2G5BFM	60	58	15	77	95	-
3/4"	380E3/4G5RF	380E3/4G5BF	60	66	20	80,5	95	-
1"	380F001G5RF	380F001G5BF	40	80	25	99,5	115	-
1" 1/4	380G11/4G5RF	380G11/4G5BF	40	97	32	104,5	115	-
1" 1/2	380H11/2G5RF	380H11/2G5BF	40	107	40	132	165	-
2"	380I002G5RF	380I002G5BF	40	131	50	140	165	-

* Bitte kontaktieren Sie das Unternehmen für Informationen über Verpackung und Mengen.

* For details on packaging and quantities, please contact the company.





VERNICKELT NICKEL-PLATED

Für Versionen 1/2" und 3/4", Verlängerungshülse aus Kunststoff PA6, 50% glasfaserverstärkt, für die Ausführungen von 1" bis 2" aus vernickeltem CW617N UNI EN 12165.

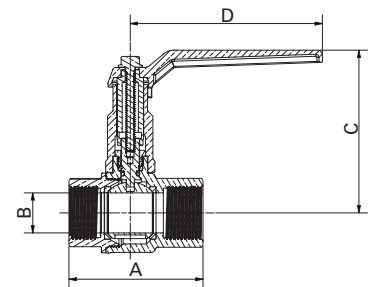
For 1/2" and 3/4" versions extension made of plastic sleeve PA6 loaded 50% glass fibre, for 1" to 2" versions of nickel-plated CW617N UNI EN 12165



Anschlüsse Connections	Produktcode Product code		PN	A ±1mm	B mm	C mm	D mm	VE klein/groß* Pack. num. pieces*
 								
1/2"	380D1/2C5RFM	380D1/2C5BFM	60	58	15	77	95	-
3/4"	380E3/4C5RF	380E3/4C5BF	60	66	20	80,5	95	-
1"	380F001C5RF	380F001C5BF	40	80	25	99,5	115	-
1" 1/4	380G11/4C5RF	380G11/4C5BF	40	97	32	104,5	115	-
1" 1/2	380H11/2C5RF	380H11/2C5BF	40	107	40	132	165	-
2"	380I002C5RF	380I002C5BF	40	131	50	140	165	-

* Bitte kontaktieren Sie das Unternehmen für Informationen über Verpackung und Mengen.

* For details on packaging and quantities, please contact the company.



Mit Verlängerung und Hebel aus tiefgezogenem Stahl
With extension stem and drawn steel lever

AUSSEN VERNICKELT
EXTERNALLY NICKEL-PLATED

Für Versionen 1/2" und 3/4", Verlängerungshülse aus Kunststoff PA6, 50% glasfaserverstärkt, für die Ausführungen von 1" bis 2" aus vernickeltem CW617N UNI EN 12165.

For 1/2" and 3/4" versions extension made of plastic sleeve PA6 loaded 50% glass fibre, for 1" to 2" versions of nickel-plated CW617N UNI EN 12165

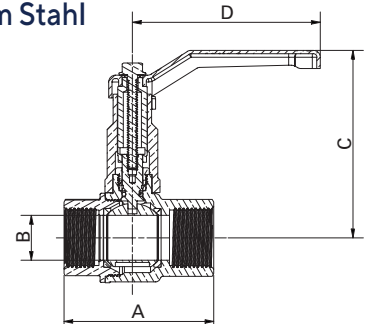

Anschlüsse Connections	Produktcode Product code	PN	A ±1mm	B mm	C mm	D mm	VE klein/groß Pack. num. pieces
1/2"	380D1/2G1RFM 380D1/2G1BFM	60	58	15	79,5	83	30
3/4"	380E3/4G1RF 380E3/4G1BF	60	66	20	83	83	25
1"	380F001G1RF 380F001G1BF	40	80	25	105	90	25
1" 1/4	380G11/4G1RF 380G11/4G1BF	40	97	32	110	90	20
1" 1/2	380H11/2G1RF 380H11/2G1BF	40	107	40	134	160	10
2"	380I002G1RF 380I002G1BF	40	131	50	142	160	10



VERNICKELT
NICKEL-PLATED

Für Versionen 1/2" und 3/4", Verlängerungshülse aus Kunststoff PA6, 50% glasfaserverstärkt, für die Ausführungen von 1" bis 2" aus vernickeltem CW617N UNI EN 12165.

For 1/2" and 3/4" versions extension made of plastic sleeve PA6 loaded 50% glass fibre, for 1" to 2" versions of nickel-plated CW617N UNI EN 12165

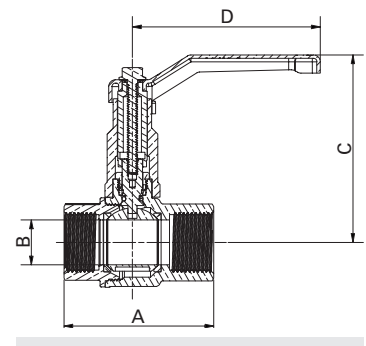

Anschlüsse Connections	Produktcode Product code	PN	A ±1mm	B mm	C mm	D mm	VE klein/groß Pack. num. pieces
1/2"	380D1/2C1RFM 380D1/2C1BFM	60	58	15	79,5	83	30
3/4"	380E3/4C1RF 380E3/4C1BF	60	66	20	83	83	25
1"	380F001C1RF 380F001C1BF	40	80	25	105	90	25
1" 1/4	380G11/4C1RF 380G11/4C1BF	40	97	32	110	90	20
1" 1/2	380H11/2C1RF 380H11/2C1BF	40	107	40	134	160	10
2"	380I002C1RF 380I002C1BF	40	131	50	142	160	10



Mit Verlängerung und Aluminium-T-Griff With extension stem and aluminium "T" handle



AUSSEN VERNICKELT EXTERNALLY NICKEL-PLATED

Für Versionen 1/2" und 3/4", Verlängerungshülse aus Kunststoff PA6, 50% glasfaserverstärkt, für die Ausführungen von 1" bis 1" aus vernickeltem CW617N UNI EN 12165.

For 1/2" and 3/4" versions extension made of plastic sleeve PA6 loaded 50% glass fibre, for 1" version of nickel-plated CW617N UNI EN 12165

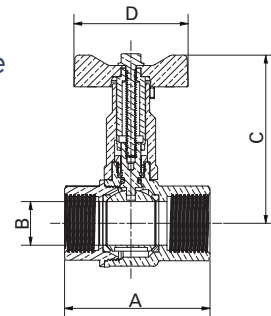
 **TRINKWASSER**
DRINKING WATER



Anschlüsse Connections	Produktcode Product code	PN	A ±1mm	B mm	C mm	D mm	VE klein/groß Pack. num. pieces	
								
1/2"	380D1/2G6RFM	380D1/2G6BFM	60	58	15	73	52	40
3/4"	380E3/4G6RF	380E3/4G6BF	60	66	20	77	52	30
1"	380F001G6RF	380F001G6BF	40	80	25	88,5	65	30





VERNICKELT NICKEL-PLATED

Für Versionen 1/2" und 3/4", Verlängerungshülse aus Kunststoff PA6, 50% glasfaserverstärkt, für die Ausführungen von 1" bis 1" aus vernickeltem CW617N UNI EN 12165.

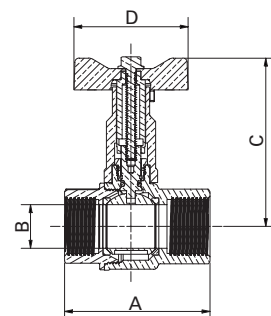
For 1/2" and 3/4" versions extension made of plastic sleeve PA6 loaded 50% glass fibre, for 1" version of nickel-plated CW617N UNI EN 12165



Anschlüsse Connections	Produktcode Product code	PN	A ±1mm	B mm	C mm	D mm	VE klein/groß Pack. num. pieces	
								
1/2"	380D1/2C6RFM	380D1/2C6BFM	60	58	15	73	52	40
3/4"	380E3/4C6RF	380E3/4C6BF	60	66	20	77	52	30
1"	380F001C6RF	380F001C6BF	40	80	25	88,5	65	30



Mit Verlängerung und Aluminium-Drehknopf
With extension stem and aluminium knob

AUSSEN VERNICKELT
EXTERNALLY NICKEL-PLATED

Für Versionen 1/2" und 3/4", Verlängerungshülse aus Kunststoff PA6, 50% glasfaserverstärkt, für die Ausführungen von 1" bis 1" 1/4 aus vernickeltem CW617N UNI EN 12165.

For 1/2" and 3/4" versions extension made of plastic sleeve PA6 loaded 50% glass fibre, for 1" to 1" 1/4 versions of nickel-plated CW617N UNI EN 12165

TRINKWASSER
DRINKING WATER

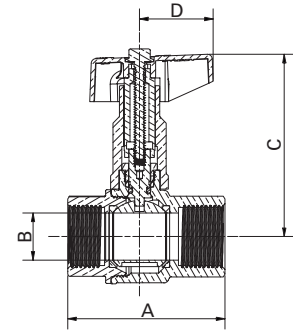

Anschlüsse Connections	Produktcode Product code	PN	A ±1mm	B mm	C mm	D mm	VE klein/groß Pack. num. pieces	
1/2"	380D1/2G2RFM	380D1/2G2BFM	60	58	15	73	31,5	40
3/4"	380E3/4G2RF	380E3/4G2BF	60	66	20	77	31,5	30
1"	380F001G2RF	380F001G2BF	40	80	25	91	42,5	30
1" 1/4"	380G11/4G2RF	380G11/4G2BF	40	97	32	105	50	20



VERNICKELT
NICKEL-PLATED

Für Versionen 1/2" und 3/4", Verlängerungshülse aus Kunststoff PA6, 50% glasfaserverstärkt, für die Ausführungen von 1" bis 1" 1/4 aus vernickeltem CW617N UNI EN 12165.

For 1/2" and 3/4" versions extension made of plastic sleeve PA6 loaded 50% glass fibre, for 1" to 1" 1/4 versions of nickel-plated CW617N UNI EN 12165

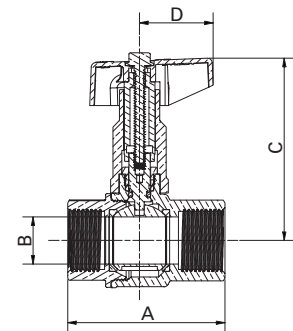

Anschlüsse Connections	Produktcode Product code	PN	A ±1mm	B mm	C mm	D mm	VE klein/groß Pack. num. pieces	
1/2"	380D1/2C2RFM	380D1/2C2BFM	60	58	15	73	31,5	40
3/4"	380E3/4C2RF	380E3/4C2BF	60	66	20	77	31,5	30
1"	380F001C2RF	380F001C2BF	40	80	25	91	42,5	30
1" 1/4"	380G11/4C2RF	380G11/4C2BF	40	97	32	105	50	20